

SEW QUICK



PROJECT NAME: PILLOW SHAMS

FINISHED SIZE: 20" x 26"

COLLECTION: MADEMOISELLE



**PILLOW 1
FABRIC A**
MMS97903
PETITES FLEURS
1 3/8 YD



**PILLOW 2
FABRIC A**
MMS97902
DOVES & BOWS
1 3/8 YD



**PILLOW 3
FABRIC A**
MMS97904
WHISPERING
1 3/8 YD

1/4" seam allowances are included.
WOF means width of fabric.

FABRIC A:

- (2) 3" x WOF strips.
- (2) 20 1/2" x 26 1/2" rectangles.
- (2) 20 1/2" x 6 1/2" strips.



ART GALLERY FABRICS®

CONSTRUCTION

Sew all rights sides together with 1/4" seam allowance.

- Sew 1 (one) 3" x WOF strip lengthwise, right sides together and press the seams open.

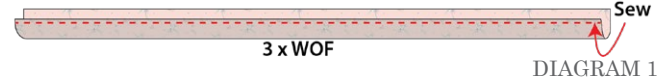

- Then cut the sewn strip in half, and sew 1 (one) end of each strip together. repeat the same steps with the other 3" x WOF strip.

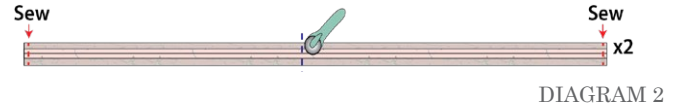

- Turn each strip inside out. You should end up with 4 (four) 1 1/4" x 21" strips in total.

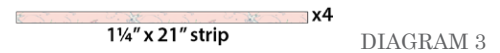

- Now, take 1 (one) 20 1/2" x 6 1/2" strip wrong side up, and fold the long side over 1/2" twice and topstitch. Make 2 of these using the 20 1/2" x 6 1/2" strip left.

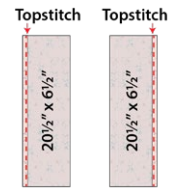

- Position 2 (two) 1 1/4" x 21" strips at 6 1/2" from the edge of both sides of a 20 1/2" x 26 1/2" rectangle in between a 20 1/2" x 6 1/2" strip. Sew the 4 (four) pieces together as shown in the diagram below, and finish the edges with a serger for a clean look. Repeat this step one more time.

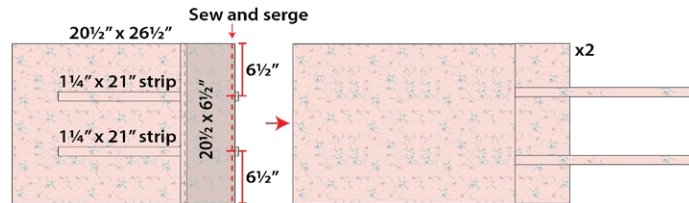

- Place 2 (two) pieces right sides facing each other, sew them together as shown in fig. 1 and finish the edges with a serger. Fold, press and tag the facing toward the inside. (Fig 2).

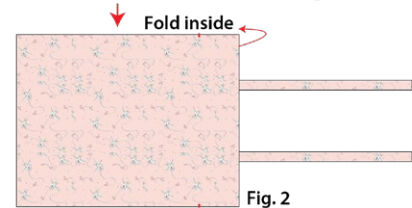
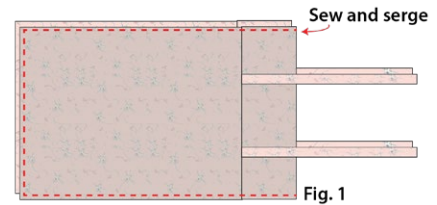

DIAGRAM 6