

# SEW QUICK

PROJECT INFO

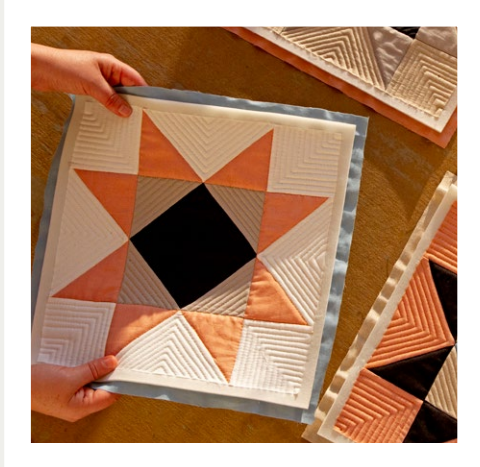

PROJECT NAME: Double Sawtooth Star

FINISHED SIZE: 12½" x 12½"

COLLECTION: LINEN BLEND SOLIDS

FABRIC REQUIREMENTS

	<b>FABRIC A</b> DENL4002 WHITE LINEN F8		<b>FABRIC C</b> DENL4004 ASHEN F8
	<b>FABRIC B</b> DENL4006 SUNKISSED F8		<b>FABRIC D</b> DENL4003 CAVIAR F8

CUTTING DIRECTIONS

¼" seam allowances are included.  
WOF means width of fabric.

**FABRIC A**

- (4) 6½" x 3½" rectangles.
- (4) 3½" squares.

**FABRIC B**

- (6) 3½" squares.

**FABRIC C**

- (4) 3½" squares.

**FABRIC D**

- (2) 6½" x 3½" rectangles.

CONSTRUCTION

Sew all rights sides together with ¼" seam allowance.

**Flying Geese Construction:**

- Place one (1) 3½" square from fabric **B** on the right edge of one (1) 6½" x 3½" rectangle from fabric **A**, mark a diagonal line from the top left to the bottom right corner of the square.
- Sew through the drawn line and trim ¼" away from the seam and press. (**Fig 1**).
- Place another 7½" square from fabric **B** on the left edge of the same unit, mark a diagonal line from the top right to the bottom left corner of the square and sew through the line. Trim ¼ inch away from the seam and press (**Fig 2**).
- Trim each unit to 6½" x 3½". Make a total of four (4) **BAB** units.

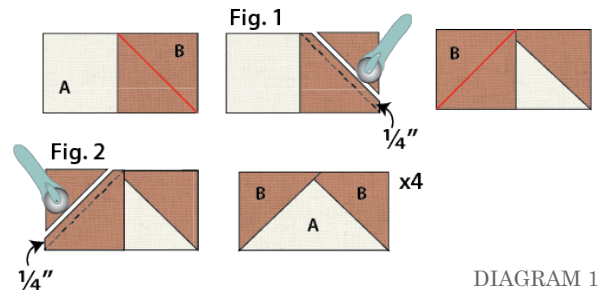

DIAGRAM 1

- Repeat the flying geese construction with (4) 3½" squares from fabric **C** (2) 6½" x 3½" rectangles from fabric **D**. Make a total of (2) **CDC** units.



DIAGRAM 2

**Block Construction**

- Start by joining (2) CDC units (See red dotted lines), then follow the diagram below for fabric placement and attachment

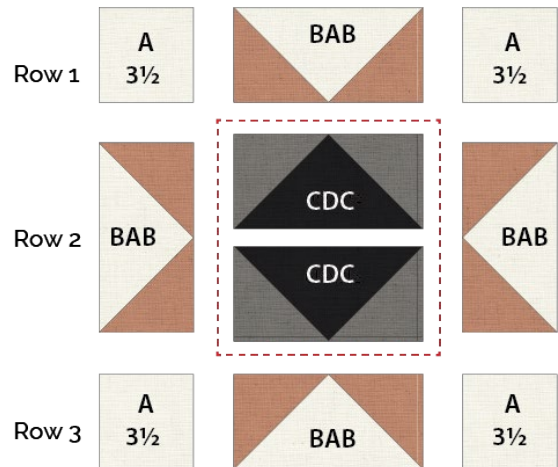

DIAGRAM 3



ART GALLERY FABRICS®