

X
X
X
X
X
X
X
X
X
X
X
X
X

The HST logo, featuring the letters 'HST' in a stylized, colorful font. The 'H' is yellow, the 'S' is red, and the 'T' is dark blue.

x x x x x x x x x x x x x x x x x x



PURE
SOLIDS

HST

PILLOW DESIGNED

AGFstudio

PURE
SOLIDS



PE-510
SWEET FIG



PE-511
DRAGON FRUIT

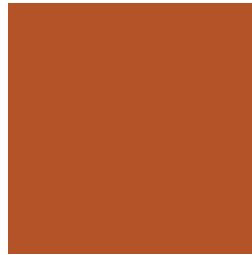

PE-512
APPLE CIDER



PE-513
GINGERBREAD



PE-514
SUMMER SUN



PE-515
OLIVE OIL



PE-516
GARDEN FERN



PE-517
EVERGREEN



PE-518
SWIMMING POOL



PE-519
PACIFIC

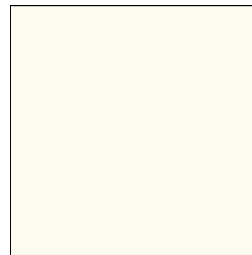

PE-408
WHITE LINEN



FINISHED SIZE | 18" x 18"

FABRIC REQUIREMENTS

Fabric A	PE-510	F8
Fabric B	PE-511	F8
Fabric C	PE-512	F8
Fabric D	PE-513	F8
Fabric E	PE-514	F8
Fabric F	PE-515	F8
Fabric G	PE-516	F8
Fabric H	PE-517	F8
Fabric I	PE-518	F8
Fabric J	PE-519	F8
Fabric K	PE-408	$\frac{7}{8}$ yd.

BACK OF THE PILLOW
Fabric **K** PE-408 (Included)

CUTTING DIRECTIONS

*1/4" seam allowances are included.
WOF means width of fabric.*

- One (1) $5\frac{3}{4}$ " square from fabric **A**.
- One (1) $5\frac{3}{4}$ " square from fabric **B**.
- One (1) $5\frac{3}{4}$ " square from fabric **C**.
- One (1) $5\frac{3}{4}$ " square from fabric **D**.



- One (1) $5\frac{3}{4}$ " square from fabric **E**.
- One (1) $2\frac{7}{8}$ " square from fabric **E**.
- One (1) $5\frac{3}{4}$ " square from fabric **F**.
- One (1) $5\frac{3}{4}$ " square from fabric **G**.
- One (1) $5\frac{3}{4}$ " square from fabric **H**.
- One (1) $5\frac{3}{4}$ " square from fabric **I**.
- One (1) $5\frac{3}{4}$ " square from fabric **J**.
- Ten (10) $5\frac{3}{4}$ " squares from fabric **K**.
- One (1) $2\frac{7}{8}$ " square from fabric **K**.
- Two (2) $18\frac{1}{2}$ " x $14\frac{1}{2}$ " rectangles from fabric **K**.

CONSTRUCTION

Sew all rights sides together with ¼"seam allowance.

- Take one (1) $5\frac{3}{4}$ " square from fabrics **A, B, C, D, E, F, G, H, I** and **J**, and ten (10) $5\frac{3}{4}$ " squares from fabric **K**.
- Pair every $5\frac{3}{4}$ " square from fabrics **A, B, C, D, E, F, G, H, I** and **J** with one $5\frac{3}{4}$ " square from fabric **K** and do the 8 at a time HST:

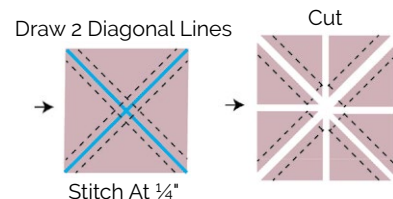
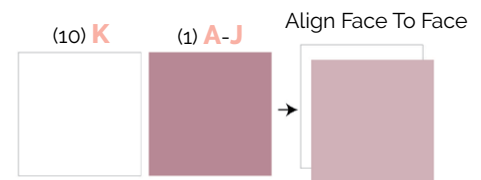

DIAGRAM 1

- Take one (1) $2\frac{7}{8}$ " square from fabrics **E** and **K** and follow the diagram to get two HST, you will only need one .

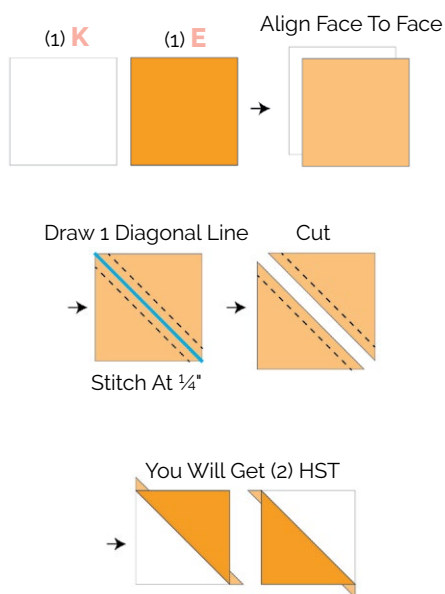

DIAGRAM 2

- For the pillow top you will need the following HST:

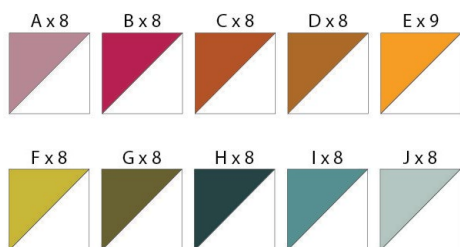

DIAGRAM 3

- Arrange the HST into rows:

Row 1: **G** - **H** - **I** - **J** - **A** - **B** - **C** - **D** - **E**

Row 2: **H** - **I** - **J** - **A** - **B** - **C** - **D** - **E** - **F**

Row 3: **I** - **J** - **A** - **B** - **C** - **D** - **E** - **F** - **G**

Row 4: **J** - **A** - **B** - **C** - **D** - **E** - **F** - **G** - **H**

Row 5: **A** - **B** - **C** - **D** - **E** - **F** - **G** - **H** - **I**

Row 6: **B** - **C** - **D** - **E** - **F** - **G** - **H** - **I** - **J**

Row 7: **C** - **D** - **E** - **F** - **G** - **H** - **I** - **J** - **A**

Row 8: **D** - **E** - **F** - **G** - **H** - **I** - **J** - **A** - **B**

Row 9: **E** - **F** - **G** - **H** - **I** - **J** - **A** - **B** - **C**



DIAGRAM 4

QUILTING ASSEMBLY

Sew rights sides together.

- Place BACKING FABRIC on a large surface wrong side up. Stretch it with masking tape against that surface.
- Place BATTING on top of backing fabric.
- Place TOP on top of the batting with right side facing up. Smooth away wrinkles using your hands.
- Pin all layers together and baste with basting thread, using long stitches. You can also use safety pins to join the layers.
- Machine or hand quilt starting at the center and working towards the corners. Remember that quilting motifs are a matter of personal preference. Have fun choosing yours!
- After you finished, trim excess of any fabric or batting, squaring the pillow top.

XXXXXXXXXXXXXXXXXXXXXXXXXXXXXXXXXXXX

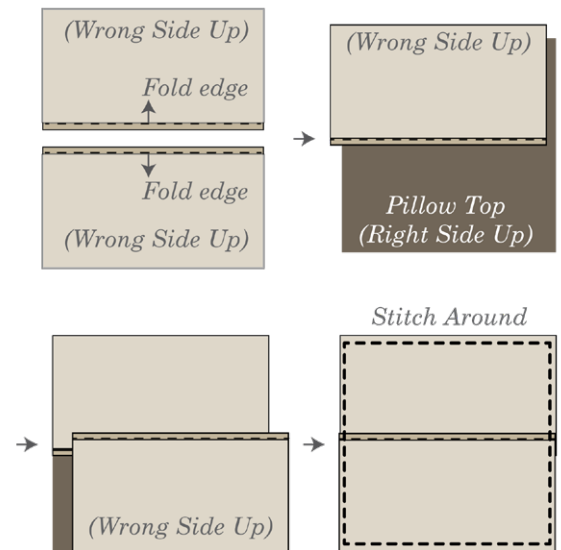

BACK OF THE PILLOW

Sew rights sides together.

- Take both 18½" x 14½" rectangles from fabric **K**.
- Fold one 18½" edge ½" towards the wrong side of the fabric of each rectangle.
- Fold the same edge ½" again and edge stitch the fold in place to have a clean edge.
- Take the quilted pillow top and lay it flat right side up.
- Take one rectangle from fabric **K** and align it wrong side up to the top side of the pillow top.
- Take the other rectangle from fabric **K** and align it wrong side up to the bottom side of the pillow top.
- Pin the three pieces in place and sew around the edges at ¼".
- Clip the corners and flip the piece to the right side of the fabric.
- Fill the pillow with a 18" x 18" pillow form and enjoy!



artgalleryfabrics.com

NOTE: While all possible care has been taken to ensure the accuracy of this pattern, We are not responsible for printing errors or the way in which individual work varies.

Please read instructions carefully before starting the construction of this quilt. If desired, wash and iron your fabrics before starting to cut.