

Kitty Cat



ANGLES

A DIVISION OF AGF

FREE PATTERN

xxxxxxxxxxxxxxxxxxxxxxxxxxxxxxxx

Kitty Cat

PROJECT DESIGNED BY AGFstudio



OH, MEOW!

FABRICS DESIGNED BY JESSICA SWIFT



OHM-33440
KATTALAND FLORA



OHM-33442
KITTEN AROUND



OHM-33444
PURRRRLANDIA



OHM-33450
CATITUDE SNOOZE

ADDITIONAL BLENDERS FOR THIS PROJECT



PE-441
BLUEBERRY ZEST



PE-433
SNOW



Kitty Cat

FINISHED SIZE | 10½" x 10½"

FABRIC REQUIREMENTS

Block 1:		
Fabric A	OMH-33440	F8
Fabric B	PE-441	F8
Block 2:		
Fabric C	OMH-33442	F8
Fabric B	PE-441	F8
Block 3:		
Fabric D	PE-433	F8
Fabric E	OMH-33450	F8
Block 4:		
Fabric D	PE-433	F8
Fabric F	OMH-33444	F8

CUTTING DIRECTIONS

¼" seam allowances are included.
WOF means width of fabric.

- One (1) 8½" x 5" rectangle from Fabrics **A, C, E, F**
- One (1) 4½" x 2½" rectangle from Fabrics **A, C, E, F**
- Two (2) 3⅞" x 3⅞" square from Fabrics **A, C, E, F**
- Two (2) 2⅞" x 2⅞" square from Fabrics **A, C, E, F**
- Four (4) 3⅞" x 3⅞" square from Fabrics **B, D**
- Four (4) 2⅞" x 2⅞" square from Fabrics **B, D**
- Two (2) 2½" x 3½" rectangle from Fabrics **B, D**
- Four (4) 1¾" x 10" strip from Fabrics **B, D**
- Four (4) 11" x 1" strip from Fabrics **B, D**

CONSTRUCTION

Sew all rights sides together with ¼" seam allowance.

Half Square Triangle (HST) Construction

- Pair Fabric **A** and **B** 3⅞" square.
- Draw a diagonal line and sew at a ¼" seam allowance on each side.
- Cut at the diagonal. Each block should measure 3½" x 3½".
- Repeat the same process again, having a total of four (4) **A-B** HST's.
- From those four, you will use two HST's following the print direction.

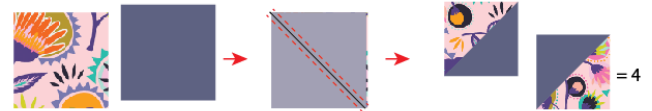

DIAGRAM 1

- Repeat the same HST construction by joining fabrics **A-B** 2⅞" x 2⅞" squares.
- Each block should measure 2½" x 2½".



DIAGRAM 2

- Now, join one 3½" x 3½" **A-B** HST's on each side on Fabric **B** 2½" x 3½" rectangle following the Diagram below.

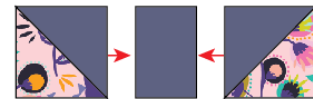

DIAGRAM 3

- Join one 2½" x 2½" **A-B** HST's on each side of Fabric **A** 4½" x 2½" rectangle following the Diagram below.



DIAGRAM 4

- Take the assembled units and Fabric **A** $8\frac{1}{2}'' \times 5''$ rectangle follow the Diagram 5 for the block construction.

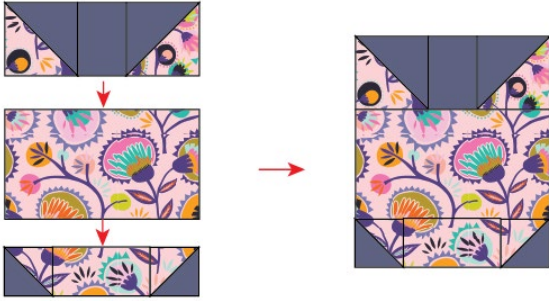

DIAGRAM 5

- Finish your block by joining one (1) $1\frac{3}{4}'' \times 10''$ strip from Fabric **B** on each side (diagram 6) and then, join one (1) $11'' \times 1''$ strip from Fabric **A** (diagrama 7).
- Square your quilt block and quilt as desired.

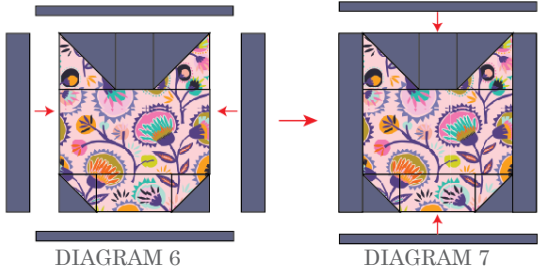

DIAGRAM 6

DIAGRAM 7



DIAGRAM 8

- To create the other blocks, just follow the same constructions.



XXXXXXXXXXXXXXXXXXXXXXXXXXXXXXXXXXXX
XXXXXXXXXXXXXXXXXXXXXXXXXXXXXXXXXXXX

*Congratulations
& enjoy*

XXXXXXXXXXXXXXXXXXXXXXXXXXXXXXXXXXXX
XXXXXXXXXXXXXXXXXXXXXXXXXXXXXXXXXXXX



artgalleryfabrics.com

NOTE: While all possible care has been taken to ensure the accuracy of this pattern, We are not responsible for printing errors or the way in which individual work varies.
Please read instructions carefully before starting the construction of this quilt. If desired, wash and iron your fabrics before starting to cut.

© 2020 Courtesy of Art Gallery Quilts LLC. All Rights Reserved.